

Bettina Werner's Artwork in Nature

ARTELAGO, Monate Lake, Italy 1990

"... The novelty of the environment, the beauty of a lake still uncontaminated, a size where human intervention and nature's presence can find the right equilibrium, represent a constant stimulus for many artists. Never as now has it been evident that Nature is our real mother. Indeed it is dangerous to believe too much in the human will and in its capability to solve all kinds of problems. Mankind is transforming itself into an infesting grass which progressively exploits the environment to exhaustion where it is growing. When resources to exhaustion exhausted the weeds will have to die.

This is the point to which humanity has arrived. There are insurmountable limits to the equilibrium between resources, on one hand, and numerical as well as economical growth, on the other. The consequence will be the exhaustion of the receptive capability of nature.

Artelago is an exhibition which directly puts in evidence the relationship between man and nature. Its beauty is infinite as infinite are the possibilities artists have or can find in order to make the necessary choices, even if they are difficult ones. Simonetta Gorreri Casini had the merit of organizing such a complex exhibition where the various installations required in-situ realization involving the contribution of many artists, chosen among the most suited in the world.

So, if we believe in the ethic, artistic and social value of this initiative and if we continue with perseverance and personal commitment to realize it, we will contribute in the preparation of a better future for our society."

Count Giuseppe Panza di Biumo
(from ARTELAGO Catalogue, 1990)



I Swear Love, 1990
Monate Lake

MUSEO DEL PARCO

PORTOFINO



The "Museo del Parco", a sculpture Museum set in a 3,500 sm lush terraced garden, that for decades belonged to Baron Von Mumm, of the German bubbly empire, contains works by some of the world's most influential artists such as Man Ray, Alberto Burri, Pietro Consagra and Arman. This outdoor Museum is nestled into a mountainside, where sculptures are displayed upon terraces and within grottos, all enjoying spectacular views of the Italian Riviera. The curator of the Museum is Daniele Crippa, who is credited for uniting Art and Nature in this wonderful setting.



Stato di sale solare, 1991
 Bettina Werner's Salt Painting Copyright © 1991

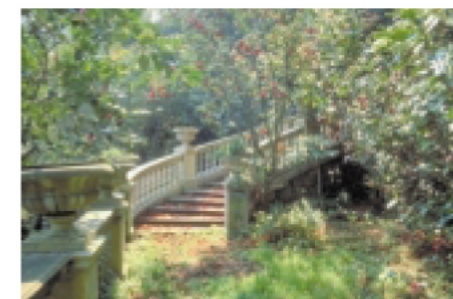
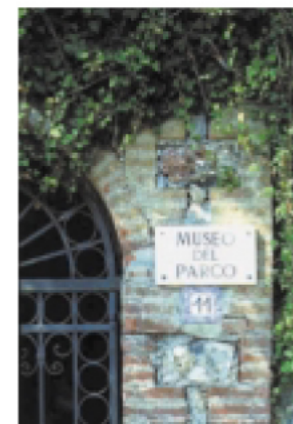



IVème Biennale de Sculpture 1993
M O N T E C A R L O
Courtesy Marisa Del Re Gallery

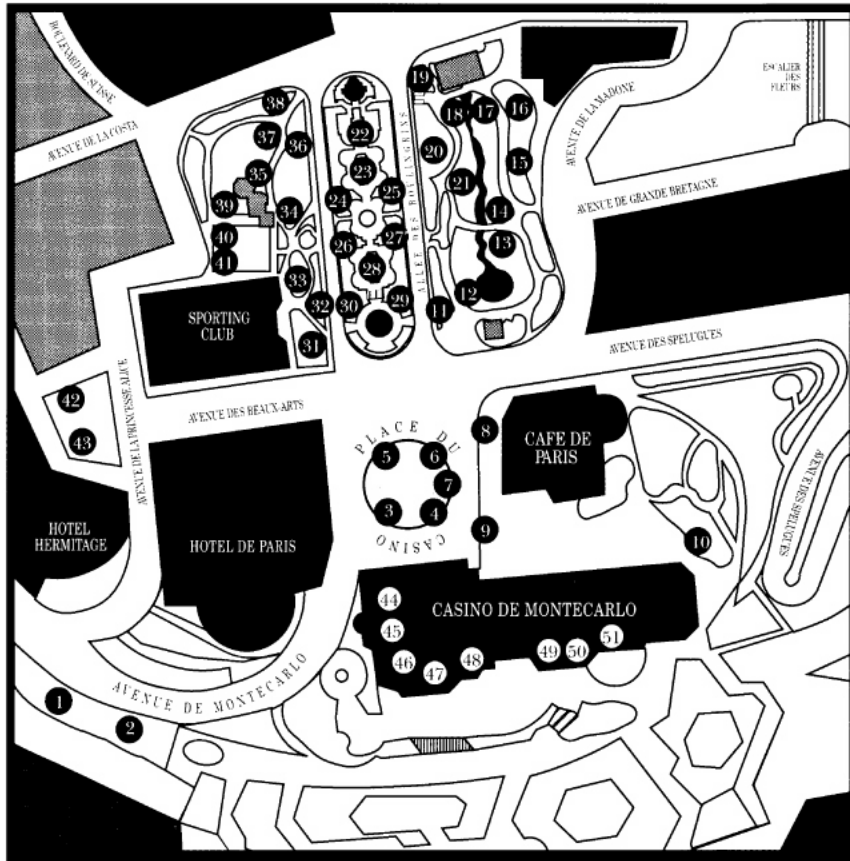

1	INDIANA	12	FOLON	23	CÉSAR	34	CORDERO	45	LEGER
2	BOTERO	13	C. LALANNE	24	DRIVIER	35	LEGER	46	LEGER
3	BOURDELLE	14	ROTRAUT	25	GREGO	36	LEGER	47	LEGER
4	RODIN	15	BARNI	26	ARMAN	37	LEGER	48	LEGER
5	MIRO	16	MENNIN	27	MIRO	38	LEGER	49	SEGAL
6	LEGER	17	F.-X. LALANNE	28	MANZU	39	MOMEN	50	CÉSAR
7	CALDER	18	VARI	29	FLANAGAN	40	SCARABELLI	51	PHILLIPS
8	FOLON	19	MUTAL	30	DUBUFFE	41	SCARABELLI		
9	MANZU	20	TROVA	31	MIRO	42	SIRONI-GUAS		
10	SOSNO	21	SCARABELLI	32	WERNER	43	VENEI		
11	ZADKINE	22	BOURDELLE	33	HAMISKY	44	LEGER		



I Swear Love, 1993
 Marble Dust, 100 X 100 cm each
 IV^{ème} Biennale de Sculpture, Montecarlo, 1993

B E T T I N A W E R N E R

International Symposium on Marble Sculpture, Thassos, Greece 1992



"E un giorno questi segni senza rumore saranno sapidi di sale greco", 1992

Eugenio Montale
28 marble pieces, 25 X 25 cm each
Bettina Werner's Marble Sculpture Copyright ©1992
Greece, Private Collection

